

# Canine Adeno virus Antigen Test

## INTENDED USE

The Canine Adeno virus Antigen Test Device is a sandwich lateral flow immunochromatographic assay for the qualitative detection of canine adenovirus antigens (CAV Ag) in canine ocular and nasal secretions.

## PRINCIPLE

The Adeno virus Antigen Test Device is based on sandwich lateral flow immunochromatographic assay. The test device has a testing window. The testing window has an invisible T (test) zone and C (control) zone. When sample is applied into the sample well on the device, the liquid will laterally flow on the surface of the test strip. If there is enough canine adenovirus antigen in the sample, a visible T line will appear in the T zone. The C line should always appear after a sample is applied, indicating a valid result. By this means, the device can accurately indicate the presence of canine adenovirus antigen in the sample.

## STORAGE AND STABILITY

Store as packaged in the sealed pouch either at room temperature or refrigerated (2-30 °C). The test is stable through the expiration date printed on the sealed pouch. The test device must remain in the sealed pouch until use. **DO NOT FREEZE.** Do not use beyond the expiration date.

## PRECAUTIONS

- Do not use after expiration date.
- Handle all specimens as if they contain infectious agents. Observe established precautions against microbiological hazards throughout testing and follow the standard procedures for proper disposal of specimens.
- Wear disposable gloves and eye protection when specimens are being tested.
- Humidity and temperature can adversely affect results.

- Do not remove test device from its pouch until immediately before use.
- Do not reuse the test kit.
- Do not mix components from different lot and different products.

## MATERIALS

- Test devices
- Dilution buffer
- Disposable swab
- Instructions for use
- Collection bag

## Sample Preparation

- Specimen (Ocular or nasal secretions) should be collected by using a swab.
- The samples should be tested immediately after collection.
- If samples cannot be tested immediately, they should be stored at 2~8°C (35.6~46.4 °F) for up to 24 hours. For longer storage, freeze at -20°C (-4 °F) or below. Frozen samples should be brought to room temperature (15~30°C/59~86 °F) before use.

## Test Procedure

- All reagents and samples must be at room temperature (15~30 °C/59~86 °F) before use.
- Collect Ocular or nasal secretions using a swab.
- Put the swab into the sample dilution buffer and stir the solution with the swab to disperse the sample into the buffer (approximately 10 seconds).
- Wait for 20 seconds to settle down the large particles.
- Remove the swab from the sample dilution buffer.
- Remove the test device from the pouch and place it on a flat and dry surface.
- Apply 3 drops of the mixed sample solution into the sample hole, drop by drop vertically
- Read test results at 10 minutes.

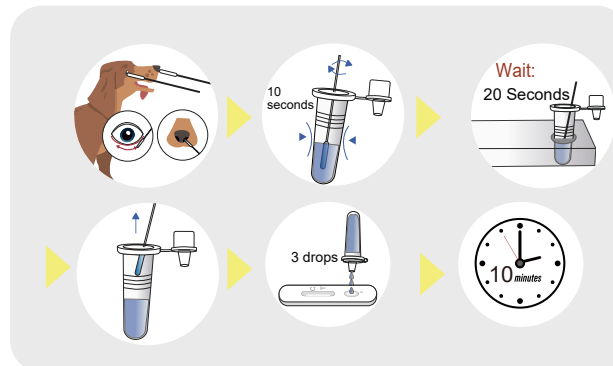

## INTERPRETATION OF RESULTS

**Positive:** The presence of both C line and T line, no matter T line is clear or vague.

**Negative:** Only clear C line appears.

**Invalid:** No colored line appears in C zone, no matter whether T line appears.

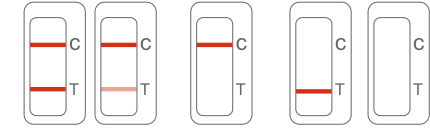

Positive

Negative

Invalid

## PERFORMANCE CHARACTERISTICS

		PCR		Total
		+	-	
CAV Ag	+	63	3	66
Test	-	5	265	270
	Total	68	268	336

Sensitivity: 92.65% (63/68, 95% C\*: 83.91%~96.82%)

Specificity: 98.88% (265/268, 95% C1: 96.76%~99.62%)

Diagnostic Agreement: 97.62% (328/336, 95% C: 95.37%~98.79%)

## LIMITATIONS

CAV Antigen Rapid Test Device is for in vitro veterinary diagnosis use only. All results should be considered with other clinical information available from veterinarian. For an accurate result, it is suggested to apply other method such as PCR for final determination in practice.

Index of Symbols			
	Attention, see instructions for use		Tests per kit
	For in vitro diagnostic use only		Use by
	Store between 2-30°C		Lot Number
	Do not use if package is damaged		Manufacturer
	Do not reuse		Catalog #
	Consult Instructions For Use		

**Manufacturer:** Feng Chun Yuan Medical Equipment (Shenzhen) Co., Ltd  
 Address: Room.1304 & Room.1306, No.48, Xinyu Road, Xiangshan Community Xinqiao Street, Baoan District, Shenzhen, Guangdong, China. 518 000



Riomavix S.L.  
 Add.: Calle de Almansa 55, 1D, Madrid 28039 Spain  
 Tel.: +34 658 396 230  
 E-mail: leis@riomavix.com



Importer & Distributor: BISAF Sp. z o.o.  
 Add: ul. Rdestowa 5, 54-530 Wrocław, Poland  
 Website: www.bisaf.pl